

Orientalmotor

ORIENTAL MOTOR U.S.A. Corp.
570 Alaska Avenue
Torrance, CA 90503
1-800-GO-VEXTA (468-3982)

Item # PAES-SY-4X, PNP Sensor Set for EAS4 (X-Axis Table Type)

The sensor set consists of three sets of a sensor, a sensor mounting bracket, a flexible sensor cable with connector (2 m) and 1 shielding plate.



Web Price

\$160.00



Specifications | Dimensions | Connection | Install

Specifications

RoHS Compliant

Yes

Dimensions

Dimensions for Sensor Installation Position (Unit mm)

The following reference diagram is an example for X table type. The Y table type is similar.

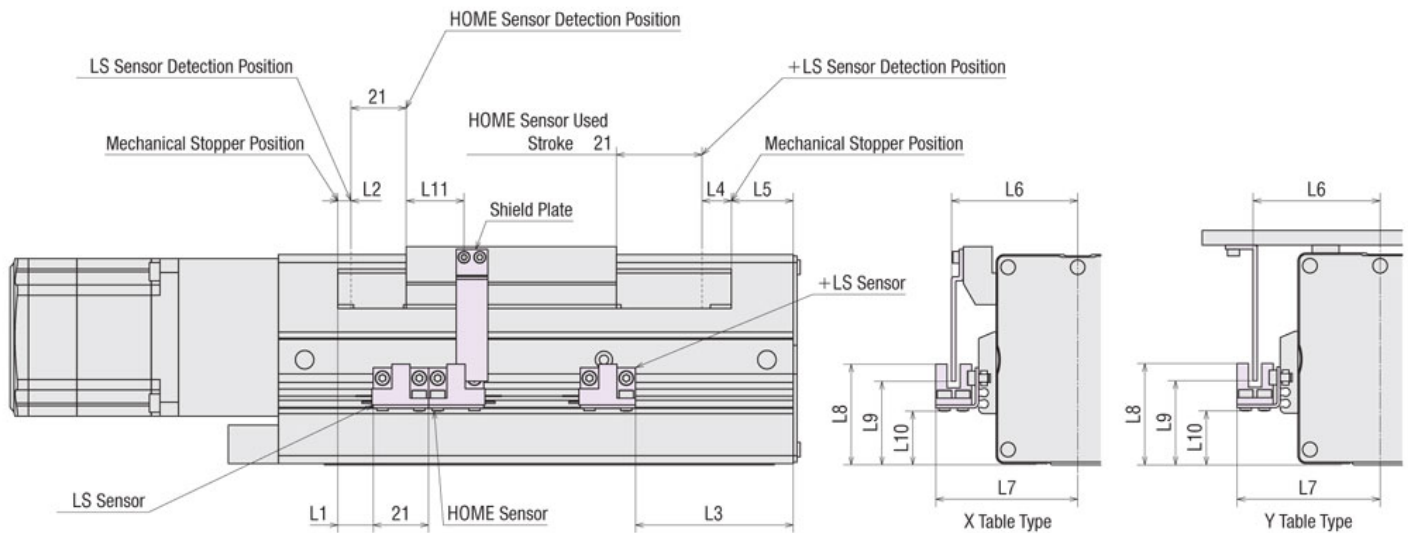

Motorized Linear Slide Model	L1	L2	L3	L4	L5	L6	L7	L8	L9	L10	L11
EAS4	5.5	2	62	2	19.5	39.5	45.5	24.3	19.3	6.6	17
EAS6	13.5	5	79	5	23.5	48	54	37.3	30.8	19	22

- If the stroke of the motorized linear slide is 50 mm, 2 sensors can be installed.
- Sensors and shield plates can also be installed on the opposite side of the diagram above.
- In case of the Y table, install the shield plate to the load.

Connection

● Sensor Output PNP Type

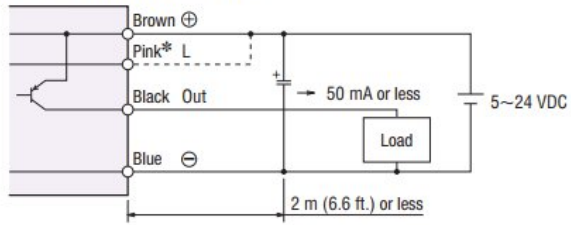

*The logic of the sensor varies depending on the connection method.

When the pink color lead is connected to the brown color lead, the sensor logic will be normally closed.

Note

- Do not disconnect the connectors for cable-equipped sensors in an energized state. This may damage the sensors.
- When disconnecting the connectors, do not pull the cables.
- If sensor wiring exceeds 2 m (6.6 ft.), insert an electrolytic capacitor (10 μ F, 50 V) within 2 m (6.6 ft.) from the sensor.

Shield Plate Installation

X-Table Type

For the X-table type, the shield plate can be installed to the table of the product. Install the shield plate included in the sensor set to the screw hole in the side of the table.

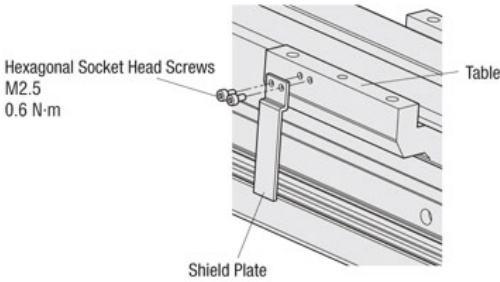

Y-Table Type

In case of the Y-table type, install the shield plate to the load. The screw hole, into which the shield plate is installed to the load, needs to be processed. For the positions of the screw holes for installing the shield plate, refer to the shield plate installation hole position reference diagrams.

The shield plate must be installed in a way that will not interfere with the sensors. The shield plate dimensions for the Y-table type are shown below. Confirm that the shield plates do not interfere with the sensors. If the included shield plates cannot be used, prepare separate shield plates.

Shield Plate Installation Hole Position Dimensions (Unit mm)

EAS4

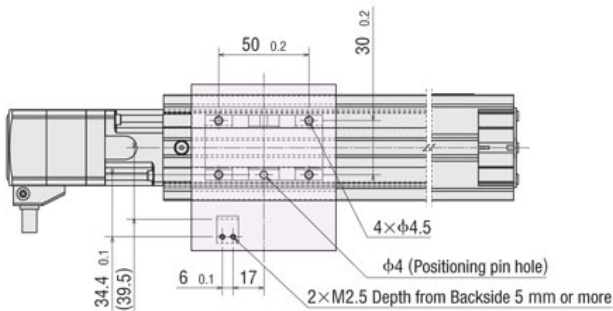

EAS6

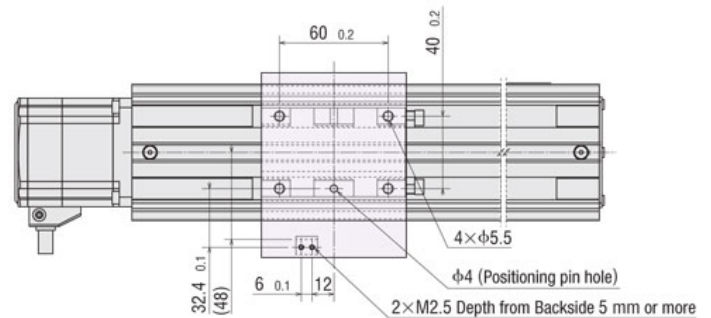

Shield Plate Dimensions (Unit mm)

EAS4

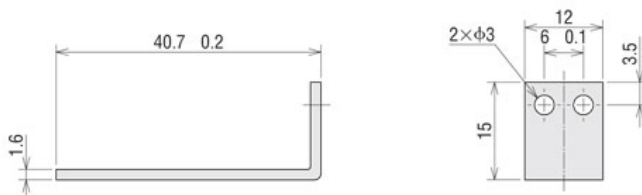

EAS6

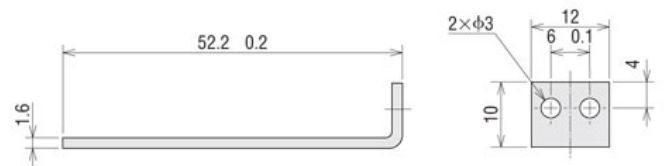

¹ Quoted Ship Date for orders placed before 12:00 pm PST. Quantities may affect Shipping Date.